

## Exhibit C

### Project Specific Safety Plan--Quincy Paving Project

**1. General Project Safety:** Contractor will apply applicable safety practices to all aspects of this project where such safety practices are regulated (Call-before-U Dig, , trench-shoring requirements, etc.), as well as best-practice safety measures to ensure that all employees, children, and the public accessing this facility or exposed to the construction site are kept safe from any general or specific construction hazards (open trenches, ditches and holes, tripping hazards, impalement hazards, impacts by construction materials or vehicles, dropped tools, materials or debris, etc.). These practices may involve strategies such as safety fencing, signs, caution tape, cones, rebar caps, spotters, tool & debris management, rerouting of foot or vehicle traffic as necessary, etc..

**2. Communication:** Good communication is required during this project. Contractor must coordinate with BOTH Inspire Facilities Department (Nathan: 509-840-3271) and the Site Manager (Imelda: 509-398-5272) at least two business days prior to project commencement. Failure to do so (especially showing up unannounced), may result in a delay to the project start with the Contractor being responsible for any incurred travel costs/time. Contractor will also inform Facilities/Site Manager of any significant unanticipated hazards that develop on the project, and immediately coordinate any required actions to resolve the issue. Additional contacts--Inspire Risk & Safety (Joel: 509-367-4621).

**3. Temporary Safety Fencing:** Contractor WILL provide a temporary fencing in several areas of this project—See *attached site map*.

Temporary safety fencing, when installed in child-containment applications (Entry Corridor & Southern Fence Replacement), must be 4' minimum in height, installed with minimal drooping (in no case less than 44"), and supported at least every 10'. The fencing must be of a continuous nature (mesh fencing vs. caution tape barriers, etc.) and secured so as to reasonably deny access vs. discourage access (i.e. no significant gaps, sagging).

**a. Main Entrance Access:** Contractor will establish a main entrance corridor from the east side of the property across from the parking lot opposite 3<sup>rd</sup> Ave. to the main entrance on the north-side of the main building (one intervening fence-run will need to be removed). This corridor must be contained by either existing fencing/buildings, and/or temporary fencing on both sides (*no access to the interior grounds without going through main entrance*). This will also double as child-containment to the north-side of the playground area, and will include a chainable temporary gate at the east entrance.

**b. Southern Interior Perimeter:** Contractor to install temporary fencing along south-side of construction site wherever permanent fencing is removed. This fencing is to be tied into existing fencing/buildings as necessary to provide a reliable barrier to keep children from accessing the construction site.

**c. North & South Paving Sites:** Contractor will install a perimeter fence and/or other means of warning/access denial around the active construction site to the extent needed to deny public access when there are any exposed hazards, and to the extent feasible during active paving operations.

**4. Paving Day(s) Safety:** Contractor will provide at least 3 days' notice prior to the beginning of active paving operations. This will allow adequate time for notice to be given to Staff and Parents of the Center's closure for that day(s).

**a. Safety Spotter(s):** Any time paving equipment is operating near public access areas (along H st., and where the alley interfaces with 3<sup>rd</sup>, etc.), Contractor will have personnel employed as safety spotter(s) and to provide traffic and pedestrian control/deconfliction, as necessary.

**5. End of Day Housekeeping:** Contractor will ensure that the construction site is left in a safe status at the end of each work day, with any portion of the site containing construction hazards being reasonably secure from intrusion or having the hazards contained/mitigated.

**6. Parking Lot Street-Crossing:** Inspire will provide 4 traffic cones with reflective collars that will be placed in the near and far parking lanes of the crossing from the parking lot opposite the temporary entrance corridor. These cones will be placed on the edge of the parking lane towards center-line, so as to be visible to street traffic from a distance, should any cars be parked in the parking lane. The cones will be placed by the Inspire employee opening the center in the morning, and stored inside the fence/gate for the night by the employee closing the center.

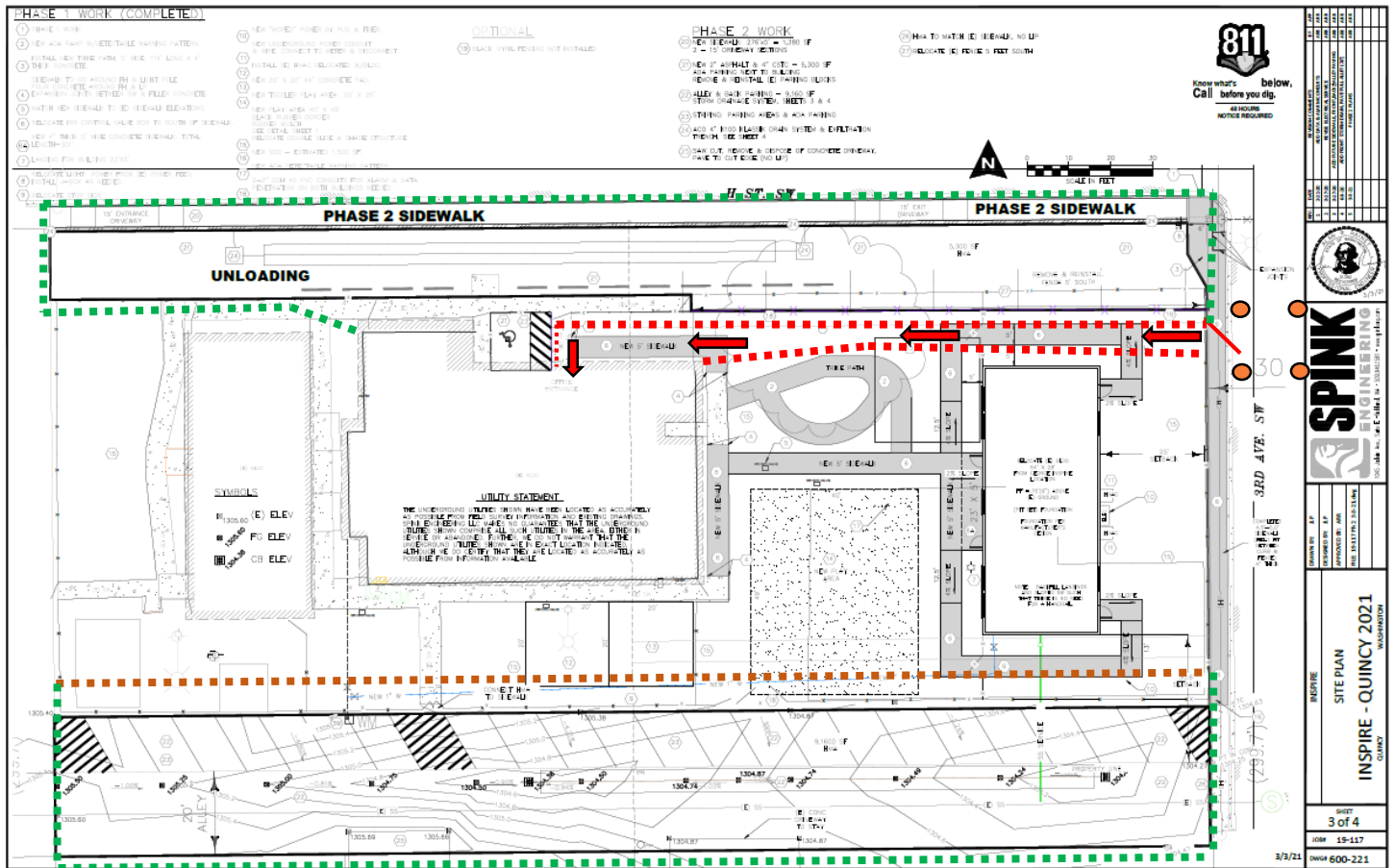

**Key:**

**Main Entrance Access Corridor**

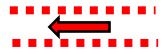

**Chainable gate**



**Parking Lot Street-Crossing Cones**



**Southern Fence Replacement**  
(where any permanent fence is removed)



**Perimeter fencing (as required)**



*Note: depicted locations are approximate*